

ALPHA FLUX

Flux-Cored Self Shielding Welding Torches gas cooled



ABICOR BINZEL.
**The right
welding torch
for every job!**

ALPHA FLUX – the new generation of Flux-Cored Self Shielding Welding Torches – suitable for extreme applications in pipeline construction, cladding and rail joint welding as well as at repair work. Equipped with quick-change torch neck, fixable at all angles as well as with the heavy duty highly flexible coaxial cable BIKOX® R for applications up to -30°C , the ALPHA FLUX offers optimal handling.

- Ceramic insulation – extreme high temperature durability.
- Robust heat protection shield made of aluminum – optimal heat deflection.
- Quick-change torch neck, fixable at all angles.
- Silver-plated contact tips – low spatter adhesion.
- Optional additional switch for adjustment of welding current.
- Highly flexible coaxial cable BIKOX® R for applications up to -30°C .

Technical Data (IEC EN 60 974-7):

Rating:	330 A with self shielding Flux-Cored Wire 60% ED
Draht-ø:	1.2 - 2.4

Type	Connector	Length	Standard	Welding current switch
ALPHA FLUX 350	KZ-2	3.00 m	013.D160	013.D158
ALPHA FLUX 350	KZ-2	4.50 m	013.D161	013.D159
ALPHA FLUX 350	LN ¹⁾	3.00 m	013.D152	013.D164
ALPHA FLUX 350	LN ¹⁾	4.50 m	013.D153	013.D165

¹⁾ LN = for wire feeders LINCOLN®

All mentioned product symbols are the property of each individual company.

Technology for the Welder's World.



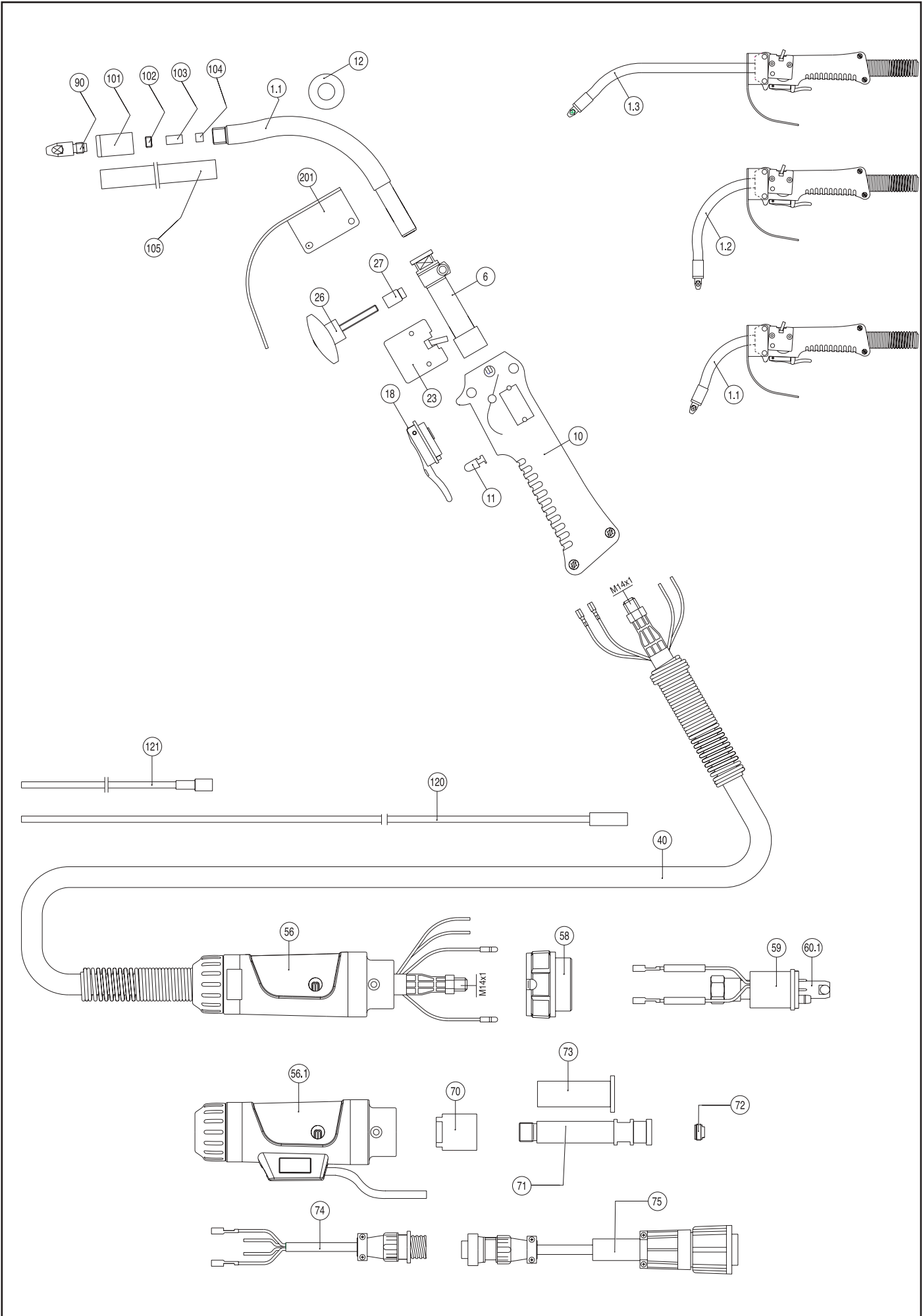

Subject to change without notice. Guarantee for Genuine Binzel Spares only.

Build group	Pos.	Description	Specifications	Part no.
Torch	1.1	Swan neck ALPHA FLUX 350 M8/65°/X=108/Y=115 ²⁾		013.D144•
	1.2	Swan neck ALPHA FLUX 350 M8/90°/X= 85/Y=157 ²⁾		013.D136
	1.3	Swan neck ALPHA FLUX 350 M8/45°/X=280/Y= 70 ²⁾		013.D169
		²⁾ Including position 102,103,104 and 105		
	no pict.	Swan neck ALPHA FLUX 350 5/16" / 65° / X=108 / Y=115		013.D162
	no pict.	Swan neck ALPHA FLUX 350 5/16" / 90° / X=85 / Y=157		013.D140
Handle	6	Torch body M14x1 FLUX		013.D154
	10	Handle FLUX cpl.		180.D051
		Handle FLUX cpl. for welding current switch		180.D052
	11	Trigger guard with stopper		400.D252
	12	Cover disc DI 14.5 mm		013.D096
	18	Trigger switch long		185.D065
	no pict.	Trigger switch short		185.D074
	23	Switch assembly (switch)		185.D085
	26	Wing screw M5x31 mm cpl.		013.D166
	27	Sleeve, insulated		013.D167
	Cable assembly KZ-2	40	BIKOX RF 35 4-wire 3.00 m	
		BIKOX RF 35 4-wire 4.50 m		160.D808
56		Connector housing, small		501.D508
		Connector housing, small for trigger wire for welding current switch		501.D507
58		Connector nut M33x2		500.0213
59		Central plug KZ-2 M 14x1		501.D378
60.1		Fixing bush M14x1 cap nut		501.0129
Cable assembly LN	40	BIKOX RF 35 4-wire 3.00 m		160.D806
		BIKOX RF 35 4-wire 4.50 m		160.D808
	56.1	Connector housing, small		501.D501
	70	Uni-Plug M14x1		501.D347
	71	Intermediate connector LN		501.9241
	72	Clamp screw LN		331.9002
	73	Insulating tube LN		501.9192
	74	Trigger wire with AMP		175.D050
	75	Trigger wire adaptor LN cpl.		175.9067
		Other trigger wire adaptors on request		
Wear parts	90	Contact tip M8; Ø 1.2 (10x30) CuCrZr silver-plated		147.0445
		Contact tip M8; Ø 1.4 (10x30) CuCrZr silver-plated		147.0536
		Contact tip M8; Ø 1.6 (10x30) CuCrZr silver-plated		147.0590
		Contact tip M8; Ø 2.0 (10x30) CuCrZr silver-plated		147.0656•
		Contact tip M8; Ø 2.4 (10x30) CuCrZr silver-plated		147.0679
	101	Insulator 1 ALPHA FLUX		013.D132
	102	Threaded pin M8/4.0 mm		013.D139•
		Threaded pin 5/16"/4.0 mm		013.D141
	103	Sleeve D=3.5 mm		013.D138
	104	Ceramic sleeve D=3.5 mm		013.D137
	105	Insulating tube 145 mm for swan neck ALPHA FLUX 350 65° bent		013.D146•
		Insulating tube 182 mm for swan neck ALPHA FLUX 350 90° bent		013.D128
		Insulating tube 278 mm for swan neck ALPHA FLUX 350 45° bent		013.D171
120	Cable liner 2.8/6.3 for wire electrodes up to Ø 2.0 for 3.00 m		122.D106•	
	Cable liner 2.8/6.3 for wire electrodes up to Ø 2.0 for 4.50 m		122.D107	
	Cable liner 3.5/7.0 for wire electrodes Ø 2.4 for 3.00 m		122.D114	
	Cable liner 3.5/7.0 for wire electrodes Ø 2.4 for 4.50 m		122.D115	

Build group	Pos.	Description	Specifications	Part no.
Wear parts	121	Neck liner 3.0 for pos. 1.1 and 1.2 for wire electrodes up to Ø 2.0		122.D110•
		Neck liner 3.0 for pos. 1.3 for wire electrodes up to Ø 2.0		122.D112
		Neck liner 3.4 for pos. 1.1 and 1.2 for wire electrodes Ø 2.4		122.D111
		Neck liner 3.4 for pos. 1.3 for wire electrodes Ø 2.4		122.D113
Miscellaneous	201	Hand shield for ALPHA FLUX		181.D002

On request:

- Other rear connectors
- Other geometries of swannecks
- Other trigger wire plugs for additional switches
- Wire conducting tip for welding in narrow gaps:
 - M8 or 5/16"
 - Length: 90 mm and 180 mm
 - Entire length insulated
- Shield caps for longer „Stickout“

Technology for the Welder's World.



Alexander Binzel Schweisstechnik GmbH & Co. KG
 Postfach 10 01 53 · D-35331 Gießen
 Tel.: ++49 (0) 64 08 / 59-0
 Fax: ++49 (0) 64 08 / 59-191
 Internet: www.binzel-abicor.com